

Central to the design of this London garden is the rill of pebbles and *Soleirolia soleirolii*. Standard olive trees to the rear of the garden should thrive in this sheltered, inner-city setting.

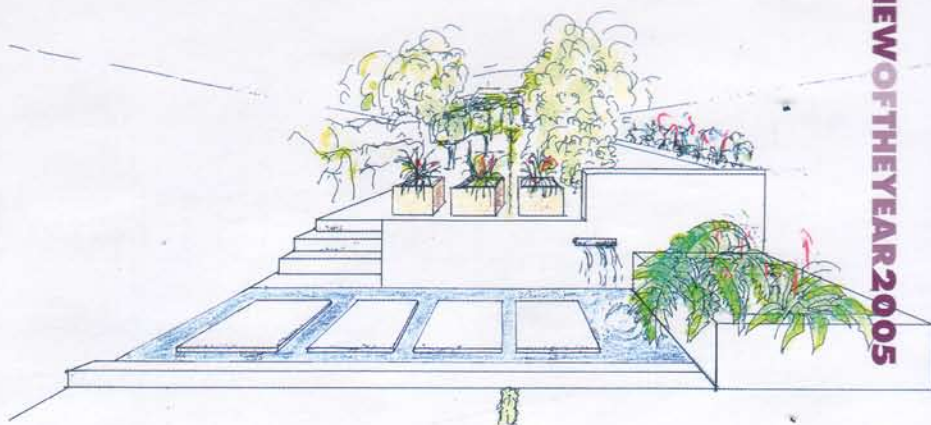

# RILL APPEAL

Clean and contemporary city garden



IMAGES: CHARLOTTE ROWE

One of Charlotte Rowe's first gardens on completing her postgraduate diploma in residential and landscape design was this 13m-long town garden. The garden was decked on two levels with the stairs to the upper level very close to the house. Rowe's brief was to push back the level change, while creating a larger usable space. Her Italian and Portuguese clients also wanted a clean and contemporary look, with simple, uncluttered planting and low maintenance requirements.

Interior remodelling of the Grade II-listed Regency property was undertaken concurrently with the exterior work, something Rowe considers to have been less than ideal in retrospect. She had to work hard to persuade her clients not to install an outdoor sauna and Jacuzzi, arguing that neither visual nor monetary value would be added in doing so.

## GARDEN FACT FILE

Designer: Charlotte Rowe. Tel: 020 7602 0660. Website: [www.charlotterowe.co.uk](http://www.charlotterowe.co.uk)

Location: Kensington, London Size: 65m<sup>2</sup>

Aspect and soil: west facing; clay soil

Project started: February 2005

Project completed: March 2005

Cost: in excess of £25,000

Design fees: 10 per cent

Hard landscape: 80 per cent

Soft landscape: 10 per cent

Contractor: HC Landscapes (hard landscape); Light IQ (lighting design)

The design uses Portuguese limestone paving, bisected by a 100mm-wide rill of dark pebbles and *Soleirolia soleirolii*. Rendered and limewashed block walls develop the clean look, and further privacy is gained by the addition of horizontal slatted trellis attached to the existing brick walls. Hand-made Iroko wood pots of *Convolvulus cneorum* break up the view to the rear of the garden. The bespoke water feature includes a spout that appears to flow from the upper level. Use of the garden is extended into the night, thanks to thoughtfully placed lighting.

