

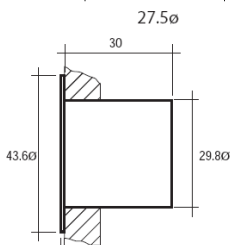

### Dimensions:

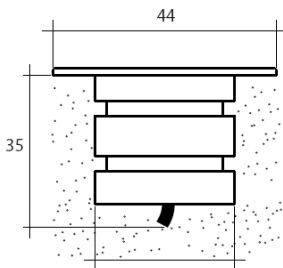

Stainless steel installation sleeve with flange

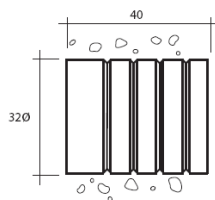

Installation sleeve for flush mounting

Please note that these drawings are not to scale

**DRIVER NOT INCLUDED.**

**CAUTION:** Care should be taken with positioning of the light fitting as it will become hot in operation.

### General Information:

A LED luminaire is suitable for mounting in interior or exterior applications such as walls, floors or joinery.

Installation is either by directly bonding into the surface or secured by 'O' rings, with the choice of 2 installation sleeves.

### Lamp:

350mA, 1w LED

### Lamp Colour Options:

Warm White (3000k approx.)

Cold White (5000k approx.)

Red

Blue

Green

Amber

### Driver Options:

Dimmable IP20

Dimmable IP68

Non-dimmable IP20

Non-dimmable IP68

### Optics Options:

6 degree lens

15 degree lens

8 x 25 degree 'spreader' lens

### Finishes:

Powder coated white

Powder coated black

Stainless steel

### Accessories:

Installation sleeve with flange

Installation sleeve for flush mounting

