



General Information:

A bathroom mirror light with integral ballast and lighting. A stainless steel bracket holds a magnifying mirror which can be swivelled or raised and lowered for ease of use.

A shaver socket is attached to the mirror at the back away for eye's view. Suitable for use in bathroom zone 2.

Lamp:

230v, 14w G5 Fluorescent (T5)



Dimensions:

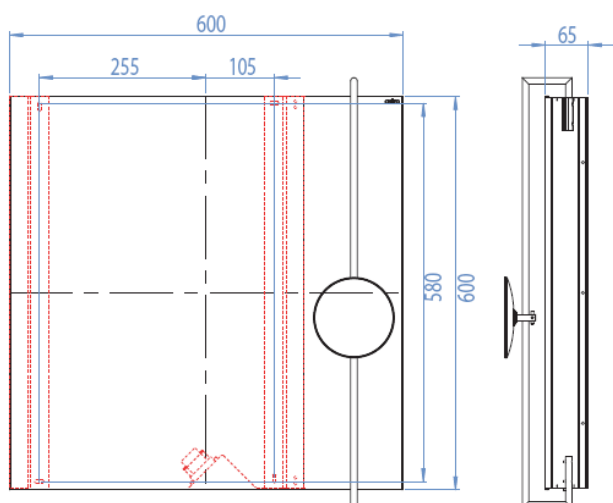

Please note that these drawings are not to scale

LAMP NOT INCLUDED.

CAUTION: Care should be taken with positioning of the light fitting as it will become hot in operation.